

Fortins
Village Classic
CAR SHOW
 downtown chilliwack

Sunday June 26, 2016
7:00am-4:00pm

Traffic Control Plan - BIA Car Show - June 26, 2016

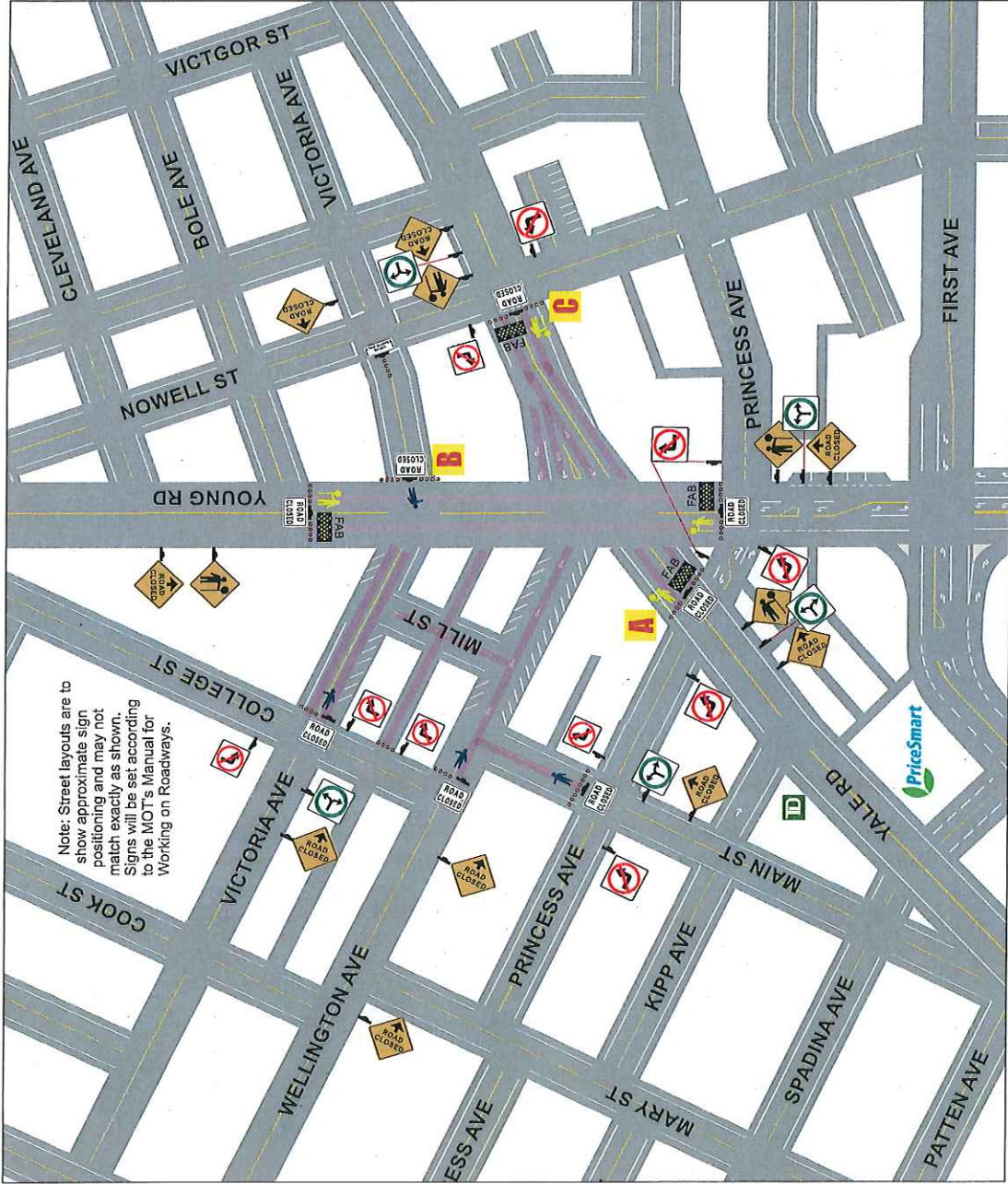

Streetwise
TRAFFIC CONTROLLERS LTD
TRAFFIC PLAN

TRAFFIC CONTROL PLAN
DATE OF LAST REVISION
2016-05-19



Contractor Name: **BIA Car Show** TCP # **TCP 1** Date: **June 26th, 2016 6am - 5pm**
 Job Description: **Car Show**

Traffic Supervisor Contact: **Angelia Fox** Phone: **604-858-7730** Email: **Angelia@StreetwiseTraffic.ca**
 Traffic Plan Contact: **Tehjay Fox** Phone: **604-799-6750** Email: **Tehjay@StreetwiseTraffic.ca**

LEGEND

	TRAFFIC CONTROL PERSONNEL		TRAFFIC CONTROL PERSONNEL
	SIGN STAND (TRIPOD)		TRAFFIC BARREL
	SIGN STAND (WINDMASTER)		TUBULAR MARKER - TYPE D
	SIGN FLAG		TRAFFIC CONTROL VEHICLE
	CLASS 1 BARRICADE		FLASHING ARROW BOARD (FAB)
	WORKZONE		

A Participant Vehicle Entrance 7:00am - 9:30am
B Vendor Vehicle Entrance 8:00am - 9:00am
C *POSSIBLE* Participant Vehicle Entrance 7:00am - 6:00am

GENERAL NOTES

- All traffic control shall conform to the TCM and the latest catalogue for Standard Traffic Signs
- Signs shown are representations of signs only and the MOTI Construction Sign Catalogue should be used for detailed sign design
- Signs shall be set up in accordance with the MOTI Construction Sign Catalogue
- All permanent signage that will conflict with this site will be removed or otherwise indicated
- Active Work Zones and Hazards shall be delineated to protect workers and the travelling public
- Maximum distance between cones/delineator/barrel should be 10m
- Maximum distance between signs will be double based and well secured during windy conditions
- Distances may be adjusted due to urban block length